

401	18180 C.O.	2,45	35% H2O, 65% H2O
402	18023, 18184	2,40	"
403	18111, 18018, 18019	1,80	40% H2O, 60% H2O
404	18112, 18019	1,80	35% H2O, 65% H2O
405	18018, 18019, 18020	1,80	40% H2O, 60% H2O
406	18020	1,80	"
407	18021, 18185	2,40	"
408	18180	2,40	40% H2O, 60% H2O

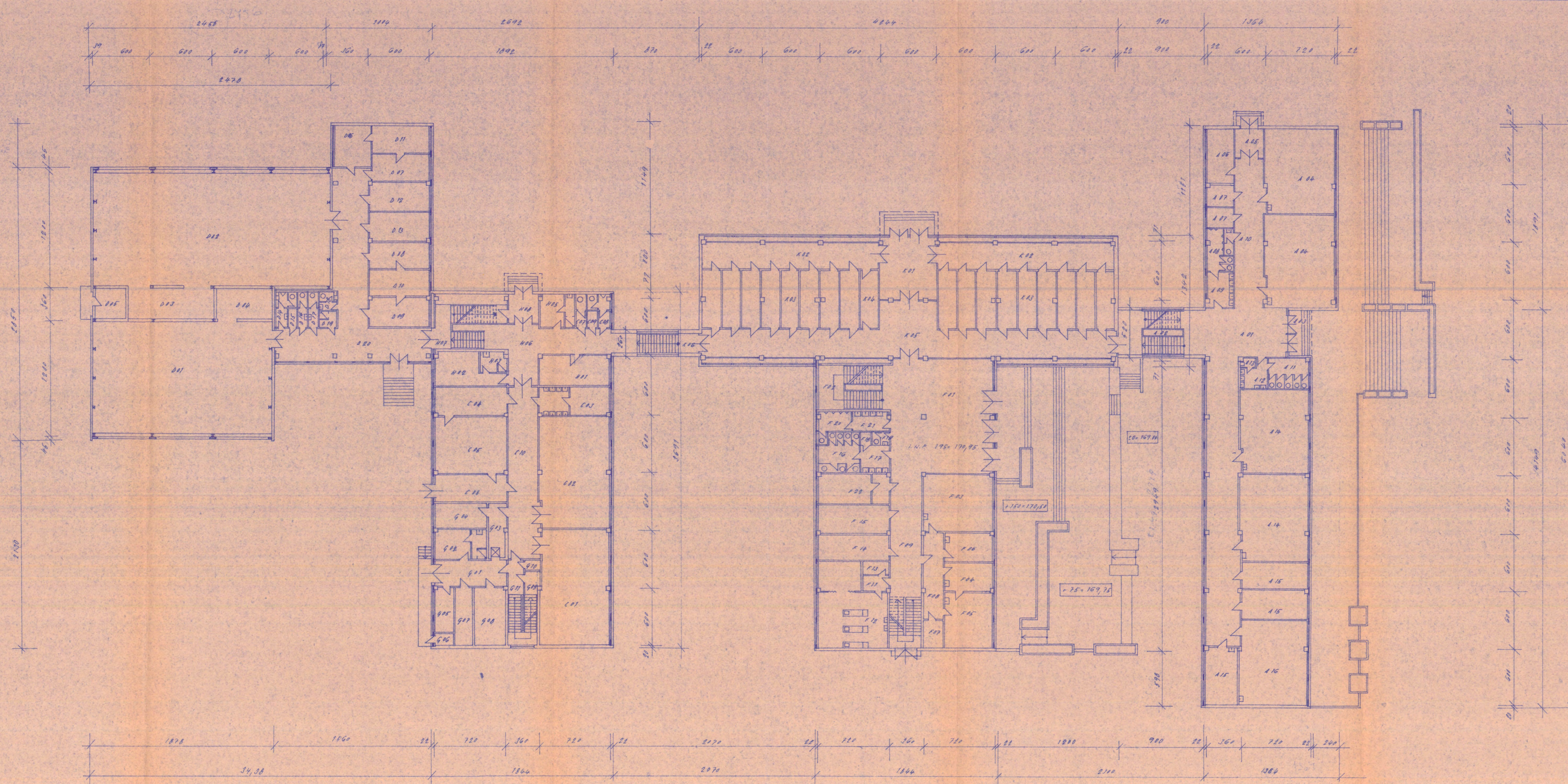

P01	PRŮSTÁVNOVÁ PLOCHA	55111	
P02	" "	153,11	
P03	" "	314,11	

[illegible]